

Lunar Landscapes



Nidhi Parikh

Project: Aaranda Exotica, Sanad, Ahmedabad
Landscape Architects: Urbscapes, Ahmedabad

Situated in the suburbs of Ahmedabad, the residential township called for a landscape idea for the common plot and the central strip garden. The challenge was to design landscape for a linear strip (10m x 100m), which would be visible from the terraces of the adjoining bungalows, along with the park for the club house. So, we decided on representing the different

phases of the Moon. The waning and waxing moons were taken as the inspiration.

On one end, depicting the full moon, is 'Poonam' plaza, which then moves on to the waning crescents and reaches the central 'Amavasya' plaza - a sunken black kadappa kund with a fountain. From there one moves to the waxing crescents and reaches the other end,

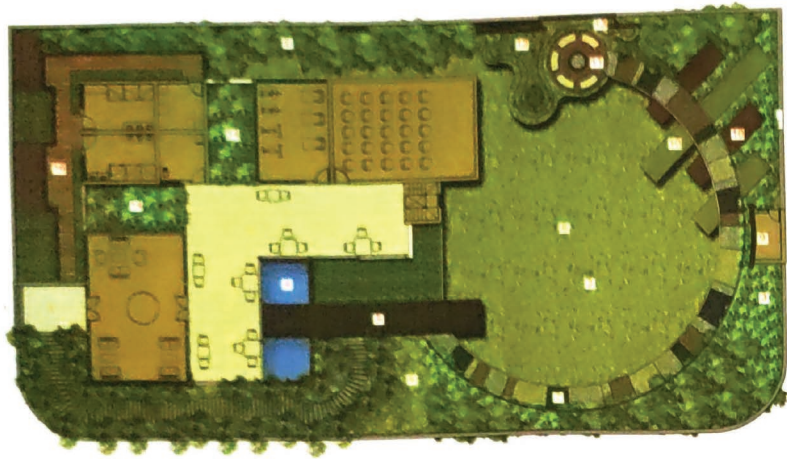

CLUB HOUSE - LANDSCAPE PLAN

1. ENTRANCE
2. ARRIVAL COURT
3. TROPICAL PLANTING
4. LILY POOL
5. WOODEN WALKWAY
6. DISPLAY OF COLOURS (MEDIUM SIZED PLANTING)
7. PALETTE WALKWAY
8. CONGREGATIONAL GREEN
9. FEATURE WALL
10. SHRUB BANDS
11. SEATING
12. MOUNT
13. SCREEN WALL
14. PALM COURT
15. SEMI-COVERED DECK
16. BRICK WALKWAY

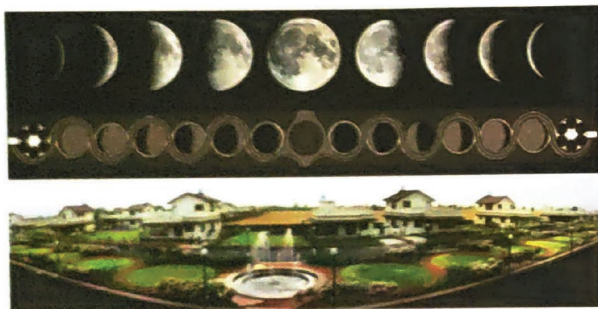

N
+ SITE PLAN



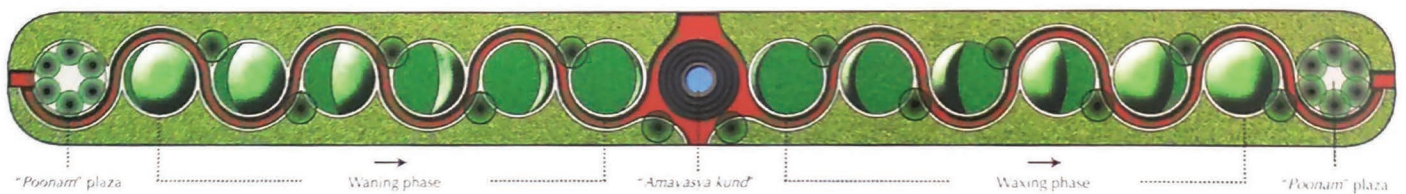

CENTRAL COMMON PLOT – LUNAR LANDSCAPE

depicting a full moon day, also called the 'Poonam' plaza, which is white marble paved with a set of five trees.

Representing the lunar phases required soil engineering to create mounds to show the separate stages, differentiated with two types of grasses and surrounded by a palette of selective native plant species offering variety of colours and aroma. All the bungalows overlook this central landscape. ☯

Factfile

Client: Abhinav Developers

Design team: Nidhi Parikh, Narendra Mangwani (Principal Architect), Jay Bhanushali, AvniKakani (Design Assistance), Devendra Shah (Designer)

Irrigation Consultant: Narayan Fuletra, Rainmake

Landscape contractor: Ramanbhai

Landscape area: 2525sq m

Year of completion: 2015